

NO.	PART NUMBER	DESCRIPTION	QTY.
1	JPM70.100.000	Left step	1
2	JPM70.100.000R	Right step	1
3	JPM31.000.001L	Front Left Bracket	1
4	JPM31.000.001R	Front right bracket	1
5	JPM31.060.000	Middle left bracket	1
6	JPM31.070.000	Middle right bracket	1
7	JPM60.030.000	Rear Left Bracket	1
8	JPM60.040.000	Rear right bracket	1
9	JPM31.030.000	Bracket	2
10	JPM31.040.000	Bracket	2
11	8550	Spacer 1/2" L=67	2
12	1248	Hex Bolt M12x1.75x30 DIN 933	2
13	1004	Hex Bolt M12x1.75x40 DIN 933	14
14	1079	Hex Bolt M12x1.75x90 DIN 931	2
15	1233	Hex Bolt M12x1.5x50 DIN 961	3
16	3001	Hex Nut Nylock M12x1.75	14
17	6006	Washer 12X27x3	19
18	6062	Washer 12x63 DIN 9021	2
19	6005	Spring washer 12 DIN 127	7

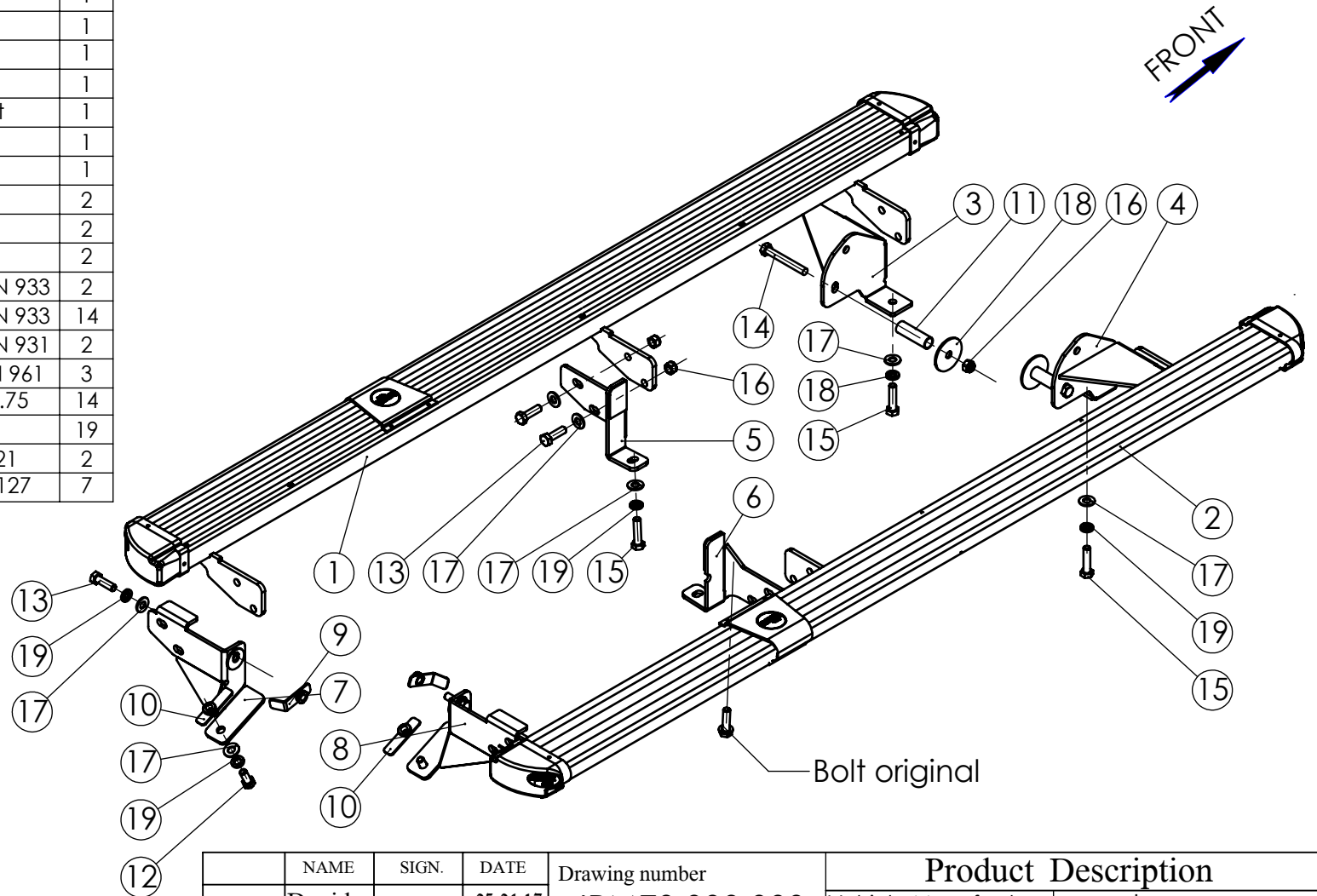

Maximum Tightening Torques

M12 (8.8)	85 Nm
-----------	-------

Confidential
 All rights in and to this document are property of ASFIR Ltd. and reserved to it. This document is forwarded to the recipient under the condition of and subject to the obligation of the recipient to keep the confidentiality of its contents. Copying transfer of distribution of this document or its contents and the use of it not for the purpose intended-are strictly forbidden.

	NAME	SIGN.	DATE
CHG.	David		05.04.17
DWN.	Charnay		01.08.11
CHKD.	David		09.04.17
CONFIRM	Dani		

ASFIR LTD.

Drawing number		Product Description	
JPM70.000.000		Vehicle Manufacturer	Jeep
Drawing description		Vehicle Model	JK Wrangler
		Vehicle Version	LWB
Side step protector black		VIN	1C4HJWFG8CL143062
		Year of Production	2007-2017
Catalogue number		Gear Shift	Automatic
547036		Motor Model	Diesel 2.8L JWF
Weight, kg 30		Transmission	Petrol 3.8L;3.6L
			4 x 4