

| NO. | PART NUMBER | DESCRIPTION | QTY. |
|-----|----------------|---------------------------------|------|
| 1 | JPW30.000.006A | Winch mounting plate | 1 |
| 2 | JPW30.030.000A | Left bracket | 1 |
| 3 | JPW30.010.000A | Right bracket | 1 |
| 4 | JPW30.020.001R | Right plate | 1 |
| 5 | JPW30.020.001L | Left plate | 1 |
| 6 | JPW30.000.007 | Holder for solonoid plate | 1 |
| 7 | LRM21.000.015E | ASFIR LOGO | 1 |
| 8 | JPW43.000.002 | Adapter for switch | 1 |
| 9 | JPW43.000.001 | Holder | 1 |
| 10 | 7218 | PIPE 1/2"x2" L=79 | 2 |
| 11 | 1133 | Hex Bolt M6x16 DIN 933 | 2 |
| 12 | 1080 | Hex Bolt M6x35 DIN 933 | 2 |
| 11 | 1209 | Hex Bolt M8x30 DIN 933 | 2 |
| 14 | 1048 | Hex Bolt M10x1.5x25 DIN 933 | 2 |
| 15 | 1248 | Hex Bolt M12x1.75x30 DIN 933 | 2 |
| 16 | 1003 | Hex Bolt M12x1.75x35 DIN 933 | 8 |
| 17 | 1014 | Hex Bolt M12x1.75x130 DIN 931 | 2 |
| 18 | 3006 | Hex Nut Nylock M6 DIN 985 | 2 |
| 19 | 3005 | Hex Nut Nylock M8 DIN 985 | 2 |
| 20 | 3037 | Hex Nut Nylock M10x1.5 DIN 985 | 2 |
| 21 | 3001 | Hex Nut Nylock M12x1.75 DIN 985 | 10 |
| 22 | 6018 | Washer 6x16 | 4 |
| 23 | 6003 | Washer 8x20 DIN 125 | 4 |
| 24 | 6006 | Washer 12x24 DIN 125 | 18 |
| 25 | 6005 | Spring washer 12 DIN 127 | 2 |

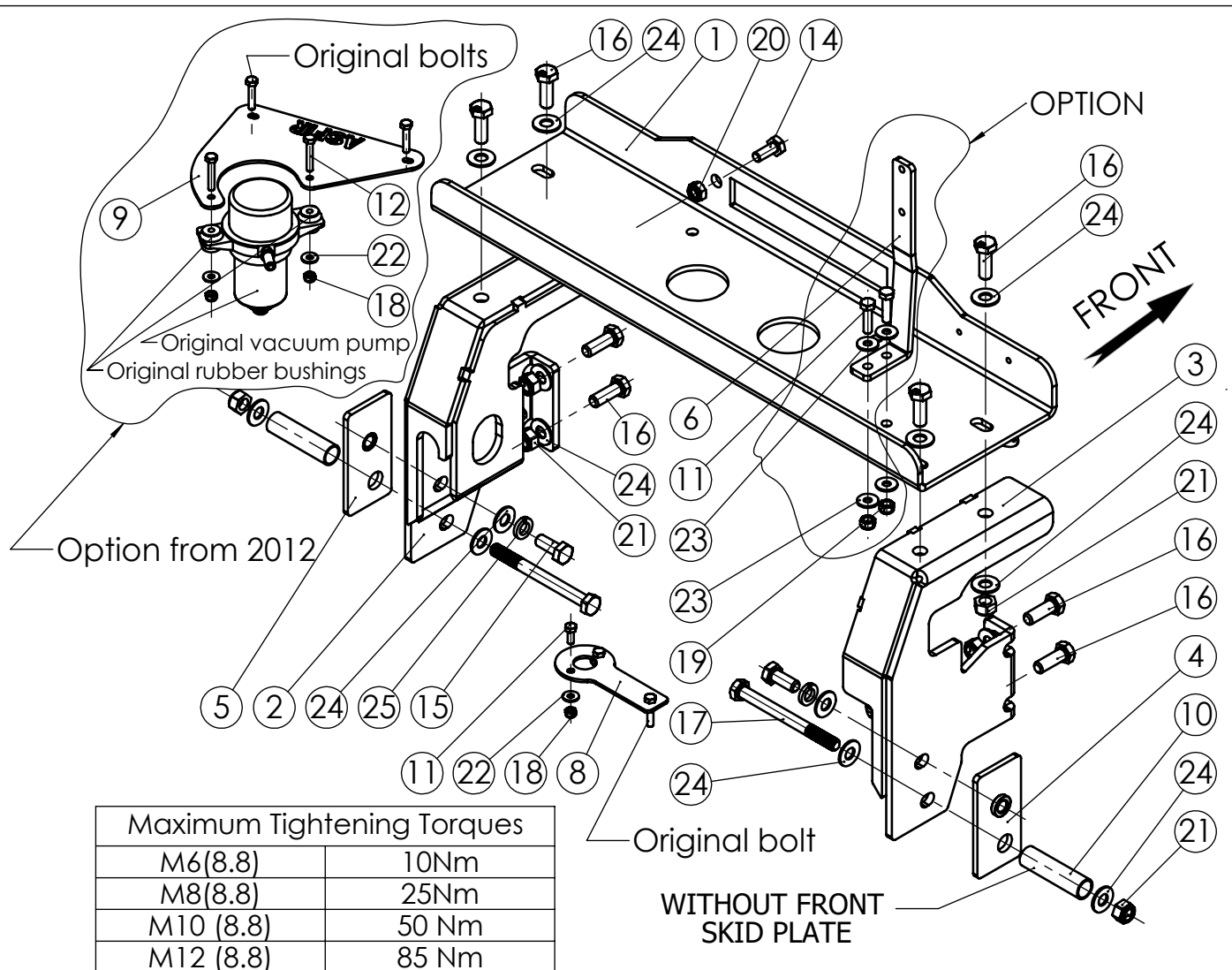

Logo plate (item 7) is fixed in ASFIR with help of two rivets 5x12.

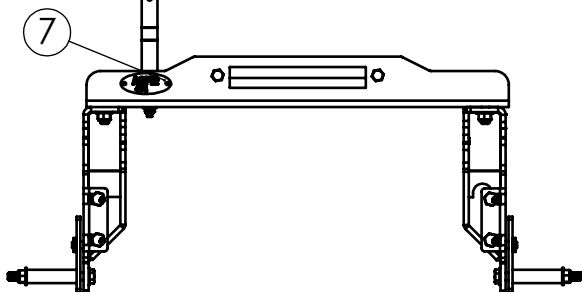

| Maximum Tightening Torques | |
|----------------------------|-------|
| M6(8.8) | 10Nm |
| M8(8.8) | 25Nm |
| M10 (8.8) | 50 Nm |
| M12 (8.8) | 85 Nm |

| | NAME | SIGN. | DATE |
|---------|-------|-------|----------|
| CHG. | David | | 26.04.17 |
| DWN. | Slava | | 12.11.07 |
| CHKD. | David | | 26.04.17 |
| CONFIRM | Dani | | |

ASFIR LTD.

| | | | | |
|---------------------|-------|--------|----------------------|--|
| Drawing number | | | JPW30.000.000A | |
| Drawing description | | | Winch mounting plate | |
| Catalogue number | | | 547020 | |
| Weight,kg | Sheet | Sheets | 1 | |

Product Description

| | |
|----------------------|--------------------------------------|
| Vehicle Manufacturer | Jeep |
| Vehicle Model | JK Wrangler |
| Vehicle Version | LWB/SWB |
| Year of Production | 2007-2017 |
| Gear Shift | Automatic |
| Motor Model | Petrol 3.8L; 3.6L Diesel 2.8 JWF5 |
| Transmission | 4 x 4 |

Confidential
All rights in and to this document are property of ASFIR Ltd. and reserved to it. This document is forwarded to the recipient under the condition of and subject to the obligation of the recipient to keep the confidentiality of its contents. Copying transfer of distribution of this document or its contents and the use of it not for the purpose intended-are strictly forbidden.