

NO	PART NUMBER	DESCRIPTION	QTY
1	TYW68.020.000	Revolving unit	1
2	TYW68.030.000	Rolling frame	1
3	TYW68.035.000	Spare wheel holder	1
4	TYW68.000.007	Adjusting plate	2*
5	TYW68.000.008	Right Joint	1
6	TYW68.000.011	Retention Disc	1
7	TYW68.000.013	Stoper	1
8	TYW68.000.014	Stoper	1
9	TYW68.000.024	Plastic plate	1
10	TYW68.000.025	Lower Bracket	1
11	TYW68.050.001	Housing	1
12	AS447.000.000	License plate light	1
13	1212	Flat socket head cap screw M6x25 DIN 7991	2
14	1128	Flat socket head cap screw M8x25 DIN 7991	4
15	1168	Hex Bolt M8x25 DIN 933	4
16	1209	Hex Bolt M8x30 DIN 933	4
17	1001	Hex Bolt M12x1.75x16 DIN 933	1
18	1248	Hex Bolt M12x1.75x30 DIN 933	2
19	1040	Hex Bolt M12x1.25x40 DIN 961	1
20	1238	Hex Bolt M12x1.75x80 DIN 931	1
21	3006	Hex Nut Nylock M6 DIN 985	2
22	3005	Hex Nut Nylock M8 DIN 985	8
23	3001	Hex Nut Nylock M12x1.75 DIN 985	1
24	6018	Washer 6x16 DIN 125	2
25	6003	Washer 8x21 DIN 125	16
26	6006	Washer 12x27 DIN 125	5
27	6001	Spring washer 8 DIN 127	4
28	6005	Spring washer 12 DIN 127	3
29	TYW68.000.000I	Instructions	1

* The number of installed "Adjusting plates" is selected at mounting of the part "Wing" TYW68.010.000 from the project TYW68.100.000.

Maximum Tightening Torques

M8 (8.8)	24 Nm
M12 (8.8)	82 Nm

Confidential

All rights in and to this document are property of ASFIR Ltd. and reserved to it. This document is forwarded to the recipient under the condition of and subject to the obligation of the recipient to keep the confidentiality of its contents. Copying, transfer or distribution of this document or its contents and the use of it not for the purpose intended are strictly forbidden.

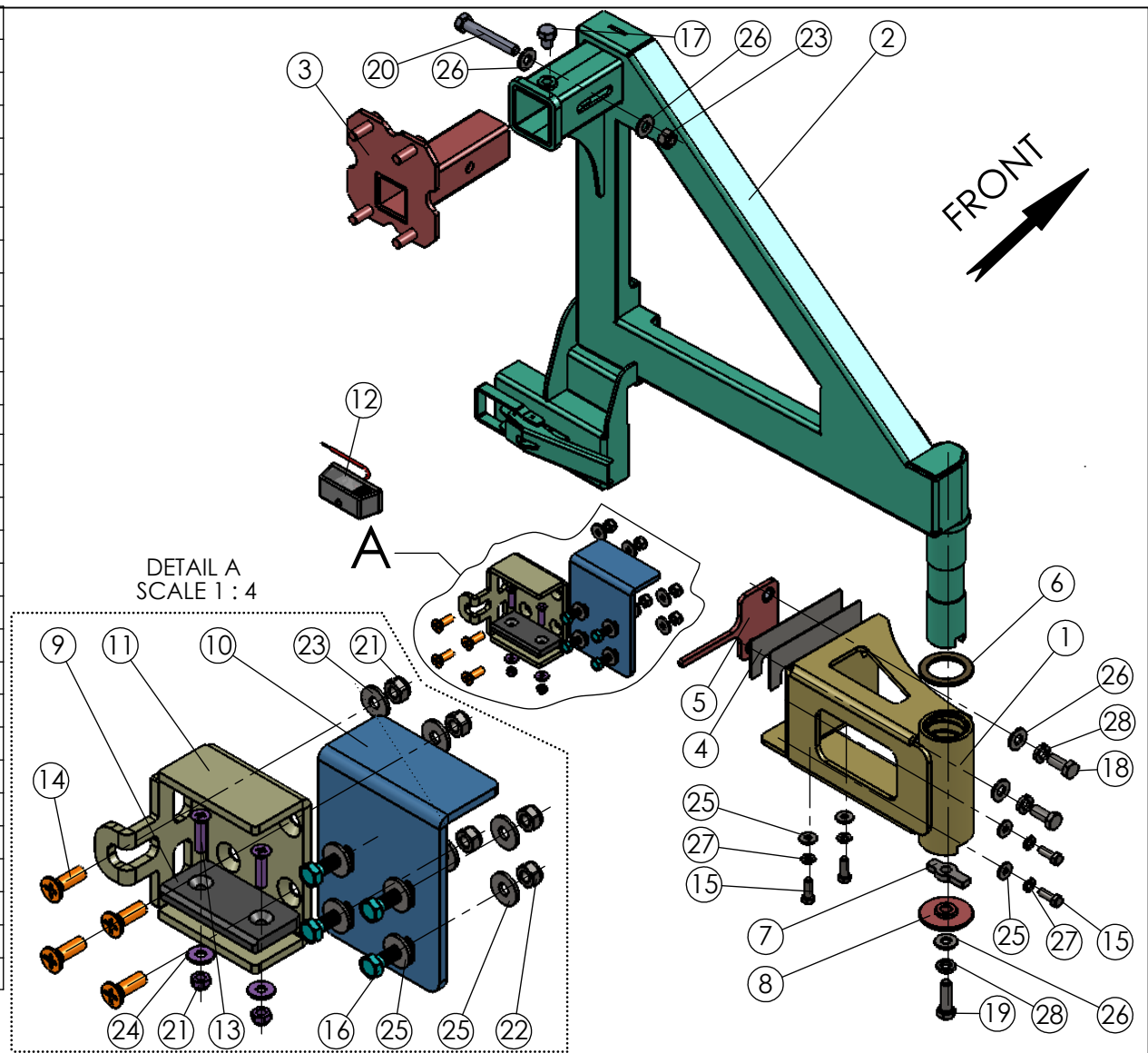

			NAME	SIGN.	DATE	Drawing number	Product Description	
CHG.						TYW68.200.000	Vehicle Manuf.	TOYOTA
DWN.	Slava		12.05.13				Vehicle Model	LAND CRUISER 80
PLN.	David					Drawing description	Vehicle Version	LWB
CONFIRM	Dani					Spare Wheel Carrier	VIN	JT3DJ81W4S0094519
ASFIR LTD.							Catalogue number	Year of Product.
						534280	Gear Shift	MANUAL/AUTOMATIC
						Weight,kg 23	Motor Model	PETROL/DIESEL
							Transmission	4X4