

NO	PART NUMBER	DESCRIPTION	QTY
1	TYW68.000.100	Asfir right wing	1
2	TYW68.010.000L	Left wing	1
3	TYW68.000.001	Right side bracket	1
4	TYW68.000.001L	Left side bracket	1
5	TYW68.000.003R	Right Cramp	1
6	TYW68.000.003L	Left Cramp	1
7	TYW68.000.005	Spacer	1
8	TYW68.000.009	Left Joint	1
9	TYW68.000.015	Spacer 1/2"x2 St.37 L=6 mm	2
10	9026	Low rubber U-shape L=0.5 m	2
11	1254	Button Head Socket Cap Screw M8X16 DIN 916	8
12	1253	Button Head Socket Cap Screw M8X25 DIN916	2
13	1168	Hex Bolt M8x25 DIN 933	4
14	1292	Mushroom head square neck Bolt M10x1.5x35 DIN 603	2
15	3005	Hex Nut Nylock M8 DIN 985	2
16	3020	Hex Nut Nylock M10x1.5 DIN 985	2
17	6003	Washer 8x21 DIN 125	16
18	6010	Washer 10x30 DIN 9021	4
19	6001	Spring washer 8 DIN 127	12

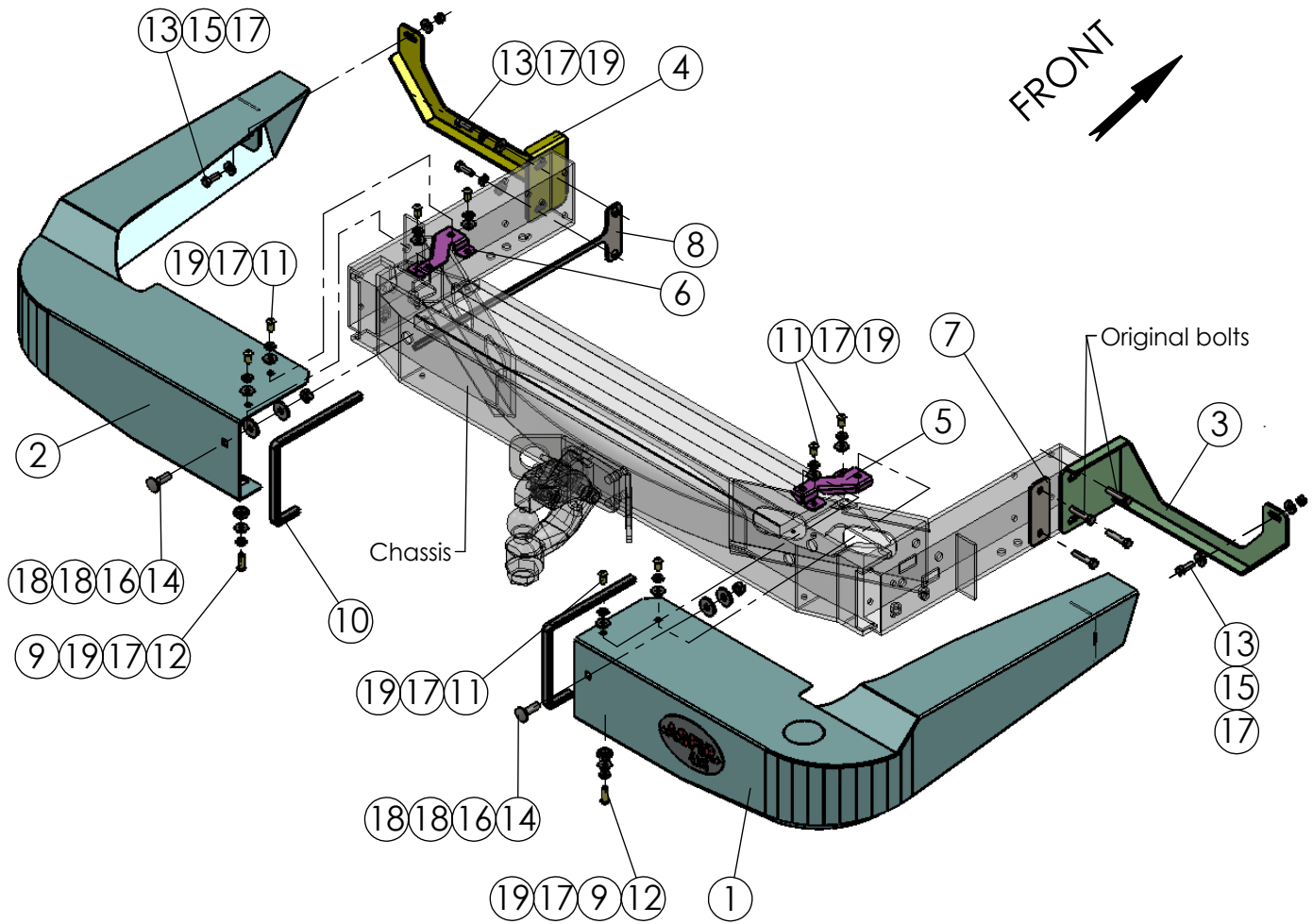

Maximum Tightening Torques	
M8 (8.8)	24 Nm
M10 (8.8)	48 Nm

Confidential
All rights in and to this document are property of ASFIR Ltd. and reserved to it.
This document is forwarded to the recipient under the condition of and subject to the obligation of the recipient to keep the confidentiality of its contents.
Copying, transfer or distribution of this document or its contents and the use of it not for the purpose intended-are strictly forbidden.

NAME	SIGN.	DATE	Drawing number	Product Description	
CHG.			TYW68.100.000	Vehicle Manuf.	TOYOTA
DWN.	Slava	20.08.12		Vehicle Model	LAND CRUISER 80
PLN.	David		Drawing description	Vehicle Version	LWB
CONFIRM	Dani		Rear Bumper	VIN	JT3DJ81W4S0094519
ASFIR LTD.			Catalogue number	Year of Product.	1991-1997
			534240	Gear Shift	MANUAL/AUTOMATIC
			Weight,kg 16	Motor Model	PETROL/DIESEL
				Transmission	4X4