

NO	PART NUMBER	DESCRIPTION	QTY
1	TYW112.010.000	Winch Plate	1
2	TYW112.000.001	Right holder	1
3	TYW112.000.002	Left holder	1
4	TYW112.000.003	Holder for bumper	4
5	TYW112.040.000	Bracket	2
6	TYW61.000.002	Spacer	2
7	JPM43.000.007	Spacer	2
8	TYW25.000.007	Adapter for switch	1
9	4054	Sponge 30X100	2
10	1104	Hex Bolt M6x20 DIN 933	6
11	1167	Hex Bolt M6x25 DIN 933	5
12	1029	Socket Head Cap Screw M10x1.5x25 DIN 912	2
13	1066	Hex Bolt M10x1.5x35 DIN 933	8
14	1018	Hex Bolt M10x1.5x55 DIN 931	2
15	1049	Hex Bolt M12x1.25x30 DIN 961	2
16	3006	Hex Nut Nylock M6 DIN 985	6
17	3037	Hex Nut Nylock M10x1.5 DIN 985	10
18	6018	Washer 6x16	11
19	6023	Washer 10x20 DIN125	22
20	6006	Washer 12x24 DIN 125	2
21	6084	Washer 6x30	4
22	6009	Spring washer 6 DIN 127	5
23	6008	Spring washer 10 DIN 127	4
24	6005	Spring washer 12 DIN 127	2
25	6946	Low Rubber U Shape for 3mm L=1.0m	1
26	TYW112.100.000I	Instructions	1

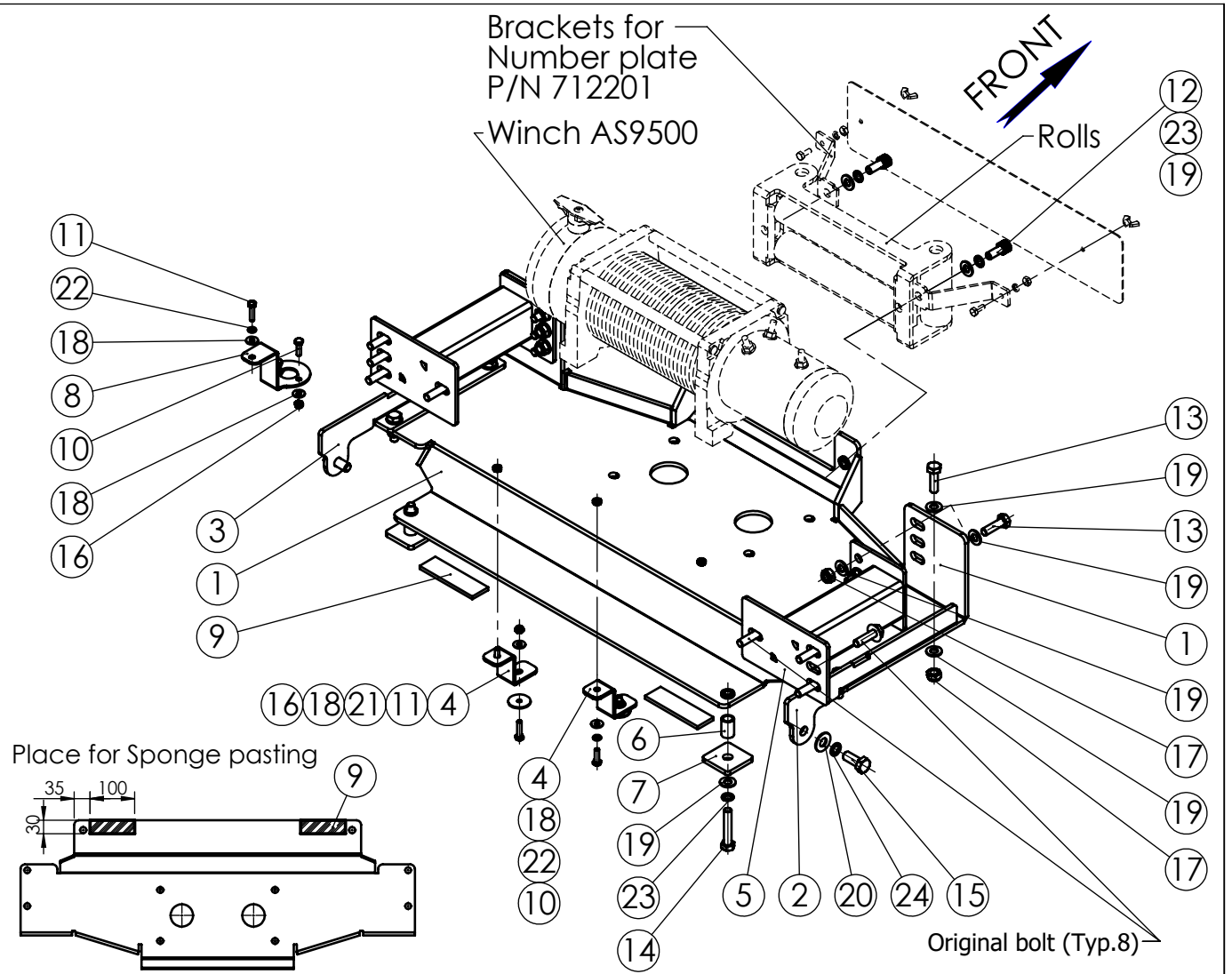

Maximum Tightening Torques	
M6 (8.8)	10 Nm
M8 (8.8)	25 Nm
M10 (8.8)	50 Nm
M12(8.8)	85 Nm

Confidential
All rights in and to this document are property of ASFIR Ltd. and reserved to it. This document is forwarded to the recipient under the condition of and subject to the obligation of the recipient to keep the confidentiality of its contents. Copying, transfer or distribution of this document or its contents and the use of it not for the purpose intended-are strictly forbidden.

	NAME	SIGN.	DATE
CHG.			
DWN.	Slava		22.01.18
PLN.	David		24.01.18
CONFIRM	Dani		

ASFIR LTD.

Drawing number		Product Description	
TYW112.100.000		Vehicle Manuf.	TOYOTA
Drawing description		Vehicle Model	LAND CRUISER 150
Hidden Winch Plate		Vehicle Version	GDJ150L-GKTEYW
Catalogue number		VIN	JTEBR3FJX0K076650
534122		Year of Product.	2018
Weight,kg 28		Gear Shift	AUTOMATIC
		Motor Model	DIESEL
		Transmission	4x4